

Illustrated Index

R. Side Cover

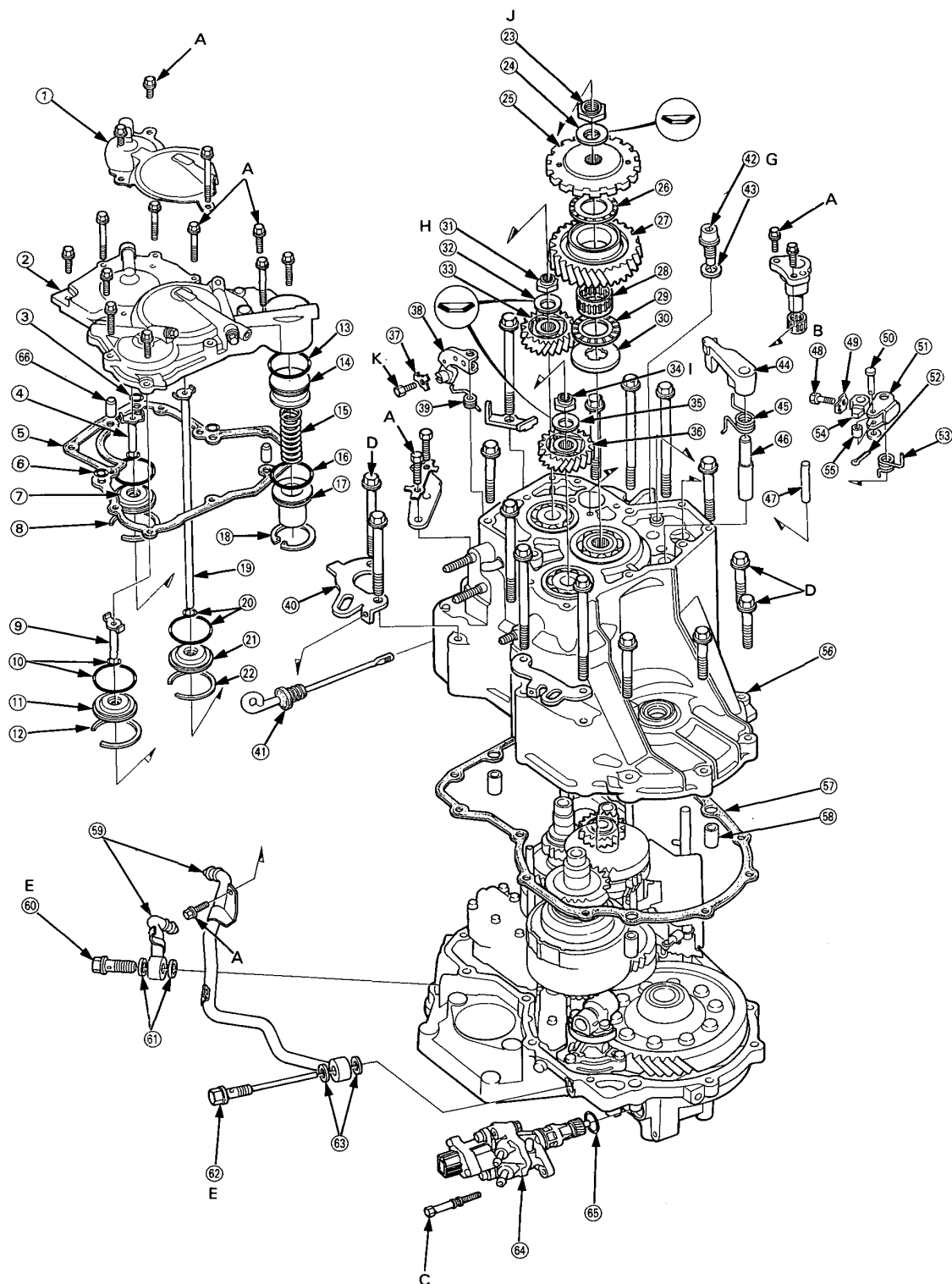



- ① R. SIDE COVER PROTECTOR
- ② R. SIDE COVER
- ③ O-RING Replace.
- ④ 4TH CLUTCH FEED PIPE
- ⑤ R. SIDE COVER GASKET Replace.
- ⑥ O-RING Replace.
- ⑦ FEED PIPE GUIDE
- ⑧ SNAP RING
- ⑨ 1ST CLUTCH FEED PIPE
- ⑩ O-RING Replace.
- ⑪ FEED PIPE GUIDE
- ⑫ SNAP RING
- ⑬ O-RING Replace.
- ⑭ 1ST-HOLD ACCUMULATOR PISTON
- ⑮ 1ST-HOLD ACCUMULATOR SPRING
- ⑯ O-RING Replace.
- ⑰ 1ST-HOLD ACCUMULATOR COVER
- ⑱ SNAP RING
- ⑲ 1ST-HOLD CLUTCH FEED PIPE
- ⑳ O-RING Replace.
- ㉑ FEED PIPE GUIDE
- ㉒ SNAP RING
- ㉓ COUNTERSHAFT LOCKNUT, 24 x 1.25 mm
(Flange nut) Replace.
- ㉔ CONICAL SPRING WASHER Replace.
- ㉕ PARKING GEAR
- ㉖ THRUST NEEDLE BEARING
- ㉗ COUNTERSHAFT IDLER GEAR
- ㉘ NEEDLE BEARING
- ㉙ THRUST NEEDLE BEARING
- ㉚ THRUST WASHER
- ㉛ MAINSHAFT LOCKNUT, 24 x 1.25 mm
(Flange nut) Replace.
- NOTE: Left-hand threads
- ㉜ CONICAL SPRING WASHER Replace.
- ㉝ MAINSHAFT IDLER GEAR
- ㉞ SECONDARY SHAFT LOCKNUT, 24 x 1.25 mm
(Flange nut) Replace.
- ㉟ CONICAL SPRING WASHER Replace.
- ㊱ SECONDARY SHAFT IDLER GEAR
- ㊲ LOCK WASHER Replace.
- ㊳ THROTTLE CONTROL LEVER
- ㊴ THROTTLE CONTROL LEVER SPRING
- ㊵ TRANSMISSION HANGER
- ㊶ ATF LEVEL GAUGE
- ㊷ DRAIN PLUG
- ㊸ SEALING WASHER Replace.
- ㊹ PARKING BRAKE PAWL
- ㊺ PARKING BRAKE PAWL SPRING
- ㊻ PARKING BRAKE PAWL SHAFT
- ㊼ PARKING BRAKE PAWL STOPPER
- ㊽ SPECIAL BOLT
- ㊾ LOCK WASHER Replace.
- ㊿ ROLLER PIN
- ① PARKING BRAKE LEVER
- ② COTTER PIN Replace.
- ③ PARKING BRAKE SPRING
- ④ PARKING BRAKE STOPPER
- ⑤ PARKING BRAKE ROLLER
- ⑥ TRANSMISSION HOUSING
- ⑦ TRANSMISSION HOUSING GASKET Replace.
- ⑧ DOWEL PIN
- ⑨ ATF COOLER PIPE
- ⑩ JOINT BOLT
- ⑪ SEALING WASHER Replace.
- ⑫ JOINT BOLT
- ⑬ SEALING WASHER Replace.
- ⑭ SPEEDOMETER SENSOR
- ⑮ O-RING Replace.
- ⑯ DOWEL PIN
- ⑰ REVERSE IDLER GEAR SHAFT HOLDER
- ⑱ NEEDLE BEARING

TORQUE SPECIFICATIONS

Ref. No.	Torque Value	Bolt Size	Remarks
A	12 N·m (1.2 kg-m, 9 lb-ft)	6 × 1.0 mm	
B	14 N·m (1.4 kg-m, 10 lb-ft)	6 × 1.0 mm	
C	18 N·m (1.8 kg-m, 13 lb-ft)	8 × 1.25 mm	
D	55 N·m (5.5 kg-m, 40 lb-ft)	10 × 1.25 mm	
E	29 N·m (2.9 kg-m, 21 lb-ft)	12 × 1.25 mm	
G	50 N·m (5.0 kg-m, 36 lb-ft)	18 × 1.5 mm	
H	230 → 0 → 170 N·m (23.0 → 0 → 17.0 kg-m, 166 → 0 → 123 lb-ft)	24 × 1.25 mm	Joint Bolt
I	230 → 0 → 170 N·m (23.0 → 0 → 17.0 kg-m, 166 → 0 → 123 lb-ft)	24 × 1.25 mm	Drain Plug
J	230 → 0 → 170 N·m (23.0 → 0 → 17.0 kg-m, 166 → 0 → 123 lb-ft)	24 × 1.25 mm	Mainshaft Locknut
K	8 N·m (0.8 kg-m, 6 lb-ft)	5 × 0.8 mm	Left-hand threads